

# House 'ALLORA' - AUCTION

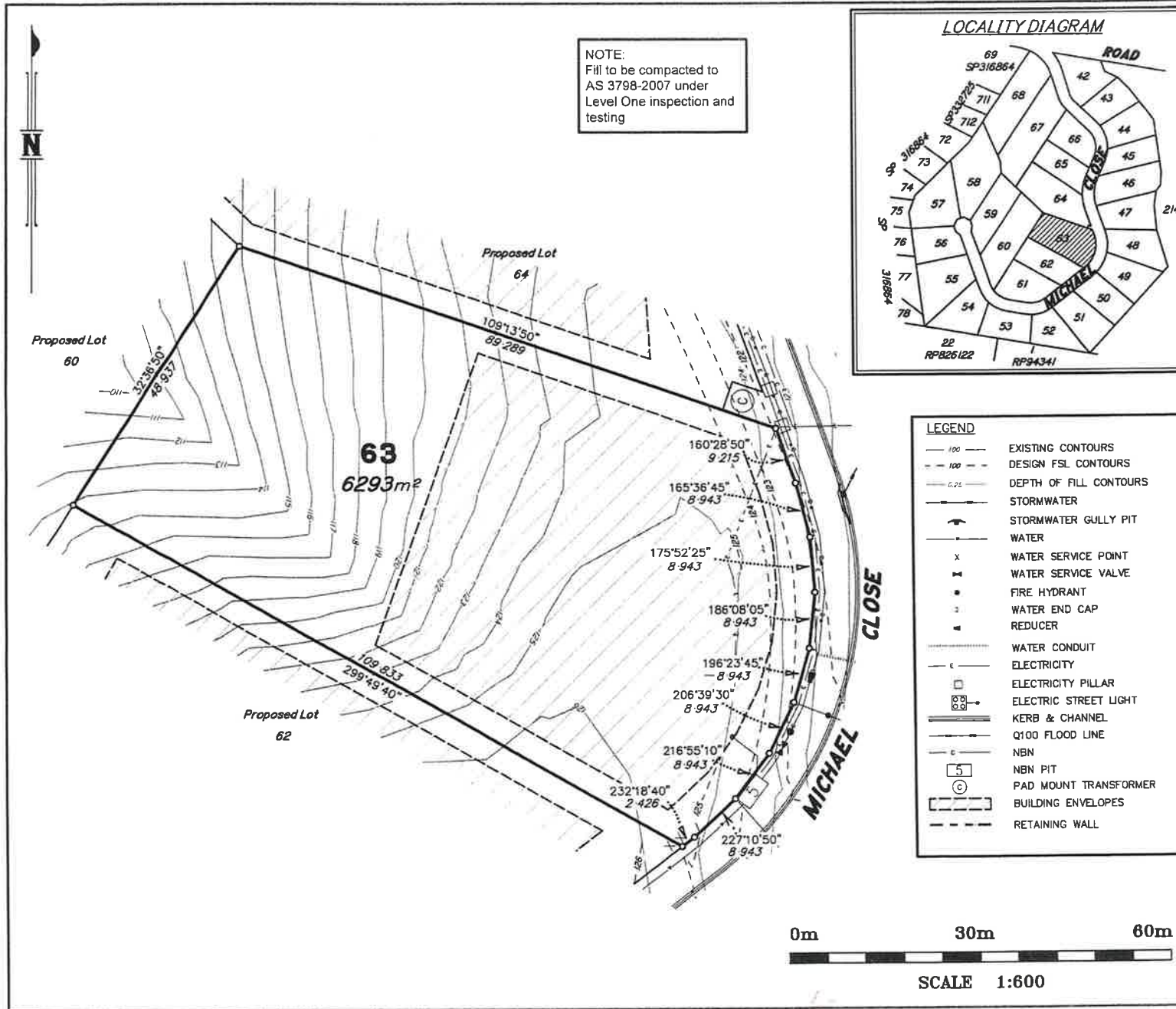

## ALLOTMENT INFORMATION DIAGRAM

For Proposed Lot 63 (SP347292)

Millstream Heights (STAGE 4)  
MICHAEL CLOSE  
Veresdale Scrub

Local Authority: Logan City Council

CLIENT: MJ, SE & AM CHRISTOFFEL

### NOTES:

- 1) This diagram has been prepared for information purposes only and does not form part of any contract of sale.
- 2) This diagram was prepared for the purpose and exclusive use of MJ, SE & AM CHRISTOFFEL and their other professional advisers and is not to be used for any other purposes or by any other person or corporation.
- 3) MJ, SE & AM CHRISTOFFEL and TJ KELLY SURVEYS PTY LTD accept no responsibility for any loss or damage arising to any person or corporation who may use or rely on this plan in contravention of these terms.
- 4) The title boundaries shown on this diagram were not marked at the time this diagram was prepared and have been determined from calculated dimensions only and not by field survey.
- 5) Easements shown are subject to final approval, field survey and title registration.
- 6) Services shown hereon have been plotted from the latest design information available at the time of preparation. The local authority and/or service provider should be contacted for "As Constructed" information prior to any design and/or construction of any structure.
- 7) These notes form an integral part of this plan. If others use this information, they should be advised of its purpose and limitations.
- 8) This plan may not be reproduced unless these notes are included.
- 9) The Building Envelopes shown may not take into consideration additional setback and clearance requirements that may be imposed by statutory and services authorities and their associated Acts and Legislation.

Areas and Dimensions are subject to plan registration. Proposed surface information is derived from digital data provided by OSKA Consulting Group 20C367-C-4 plan series.

### AUTHORIZATION:

*Timothy John KELLY* 21/10/2024  
Cadastral Surveyor Date

DATE	SURVEYED
21/10/2024	
SCALE	DRAWN
1:600	KO
MERIDIAN	CHECKED
SP332731	CH
LEVEL DATUM	
A.H.D.	



OFFICE: 111 Brisbane Street, BEAULIEU Phone: (07) 5541 4722  
POSTAL ADDRESS: PO Box 221 BEAULIEU 4285 Email: admin@tjkelly.com.au  
Web: www.tjkelly.com.au

DRAWING NO: 3550-S4-AID\_63